

Date code (TypeWeekYear)  
is printed on one side of the jack  
Type: Y-ConJack-22 -> 22

Example:  
220213: Y-Con-Jack-22 produced in  
week 02 of 2013

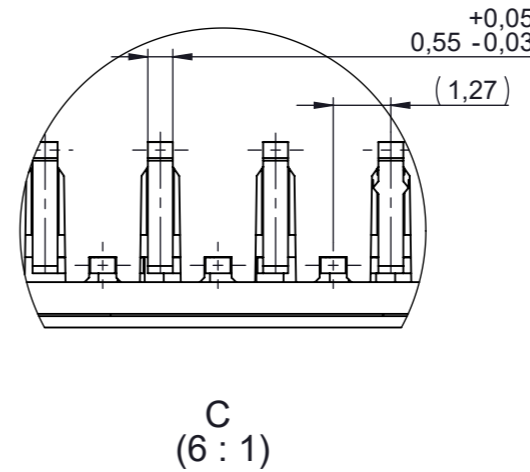
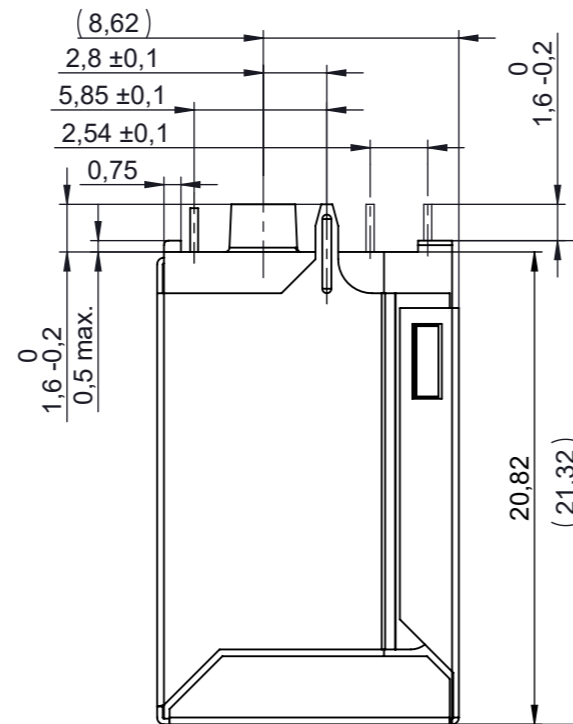
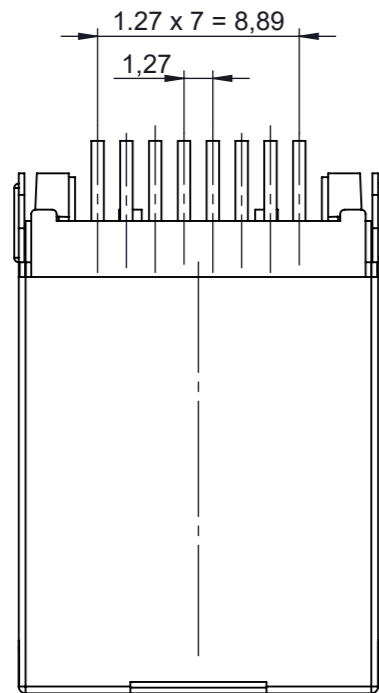
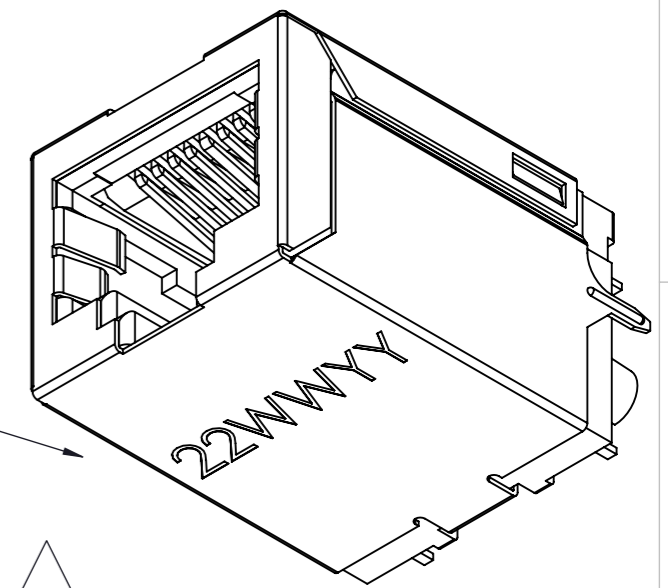

**Pick and Place Cap**  
(P(090)P850)

area for vacuum nozzle  
15,44mm x 12,90mm

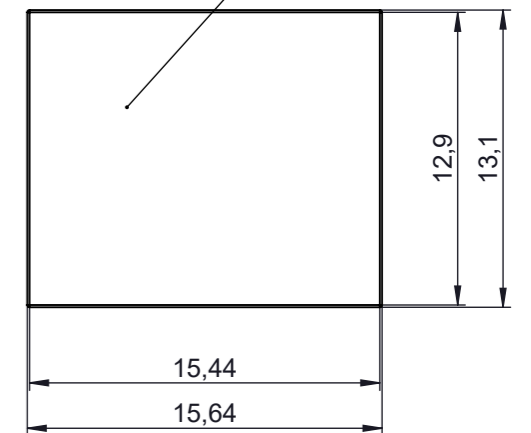

Specification See	Customer-PS(090)A35
Packaging See	Customer-PI(090)A35

Yamaichi acts with all markings of the product exclusively on behalf of the customer as service provider and not as distributor. Yamaichi is not aware of the customer's end use/application. The customer indemnifies Yamaichi from any liability towards third parties in connection with the marking - with the exception of the legal exclusions of liability according to § 309 No. 7 BGB.

- 100% Critical Dimensions to be inspected 100%.
- Critical Dimensions.
- <SPC> Critical Dimensions. To determine Cmk & Cpk.

UNLESS OTHERWISE SPECIFIED :  
DIMENSIONS ARE IN MILLIMETERS

TOLERANCES:  
ISO 2768-1 m (mittel)  
ISO 2768-2 K

ORDER / ARTICLE NO. 82-00216

**CONFIDENTIAL** Customer Drawing

RoHS compliant acc. to directive 2011/65/EU Specification/Drawing subject to alteration without prior notice.  
The information contained in this drawing is the sole property of YAMAICHI ELECTRONICS DEUTSCHLAND GMBH. Any reproduction in part or whole without the written permission of YAMAICHI ELECTRONICS DEUTSCHLAND GMBH is prohibited.

REVISION	DESCRIPTION	ID	REV. DATE
021	Packaging updated	T123	17.05.2023
020	Packaging updated	M189	22.07.2020
019	packaging unit revised	M189	21.04.2020
018	Updated DRW	RIA	14.03.2019
017	Date Code changed	RIA	19.06.2018



DO NOT SCALE DRAWING

	ID	DATE
ANGLED PROJECTION:	CREATED BEH	31.05.2011
FIRST	MODIFIED T123	06.11.2023
	RELEASED M189	07.11.2023

Description: Ethernet jack, 180°, 8(8)+2

Purchase No.: Y-CONJACK-22-THR

Drawing No.: Customer-P(090)A35

REVISION: 021

Recommended PCB LAYOUT / TOP VIEW  
 Dicke der Leiterplatte: 1,6 ± 0,16mm  
 Thickness of PCB: 1,6 ± 0,16mm

(a) Jack contour outline  
 (b) Plated holes

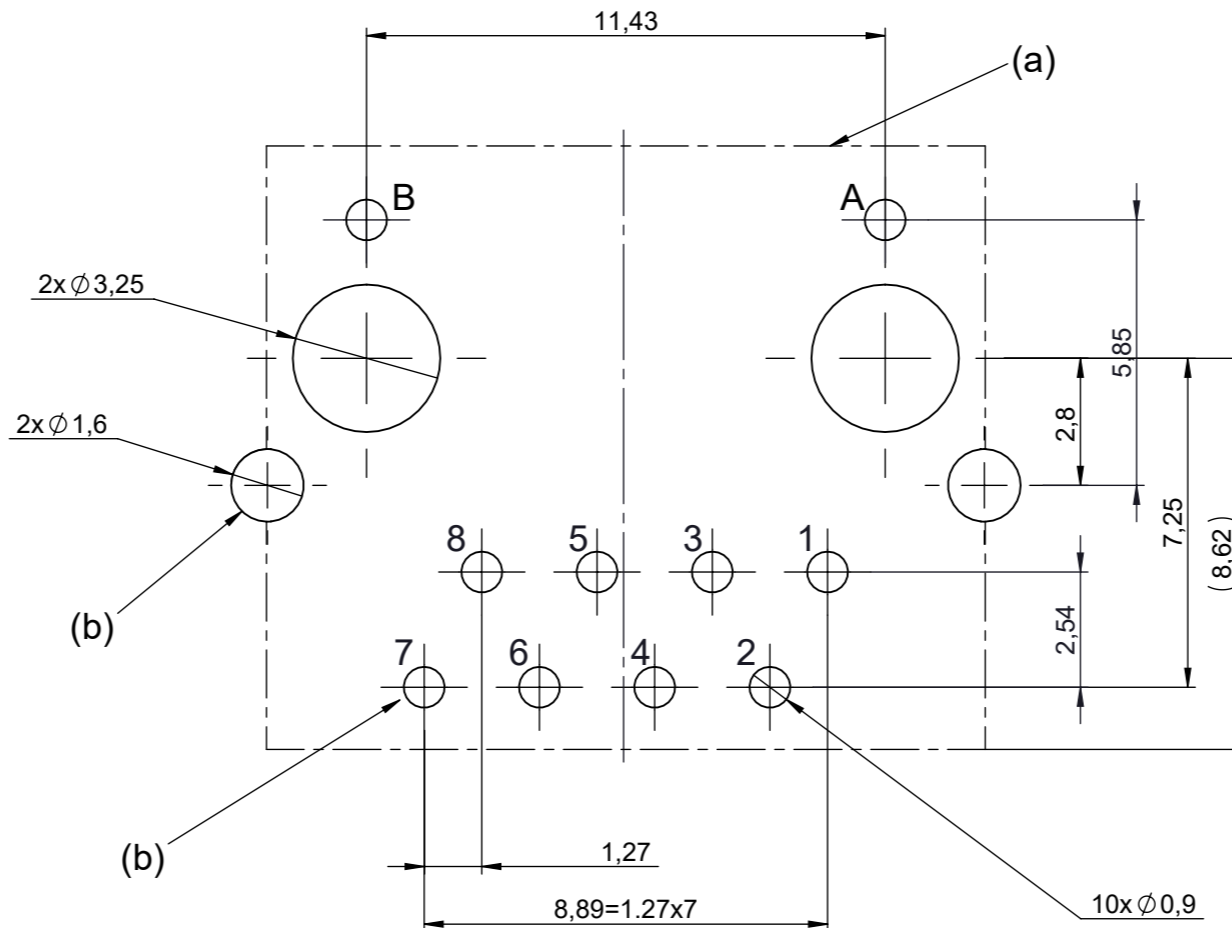

- 100% Critical Dimensions to be inspected 100%.
- Critical Dimensions.
- <SPC> Critical Dimensions. To determine Cmk & Cpk.

UNLESS OTHERWISE SPECIFIED : DIMENSIONS ARE IN MILLIMETERS

TOLERANCES:  
 ISO 2768-1 m (mittel)  
 ISO 2768-2 K

ORDER / ARTICLE NO. 82-00216

**CONFIDENTIAL** PCB Layout

RoHS compliant acc. to directive 2011/65/EU Specification/Drawing subject to alteration without prior notice.  
 The information contained in this drawing is the sole property of YAMAICHI ELECTRONICS DEUTSCHLAND GMBH. Any reproduction in part or whole without the written permission of YAMAICHI ELECTRONICS DEUTSCHLAND GMBH is prohibited.

REVISION DESCRIPTION	ID	REV. DATE
021 Packaging updated	T123	17.05.2023
020 Packaging updated	M189	22.07.2020
019 packaging unit revised	M189	21.04.2020
018 Updated DRW	RIA	14.03.2019
017 Date Code changed	RIA	19.06.2018



Description: Ethernet jack, 180°, 8(8)+2		
Purchase No.: Y-CONJACK-22-THR		
Drawing No.: Customer-P(090)A35		REVISION: 021
WEIGHT:	SUBREV02 T153 29.01.2024	SCALE: 1:1 SHEET 2 OF 2 DIN A3 - ASSEMBLY

Yamaichi acts with all markings of the product exclusively on behalf of the customer as service provider and not as distributor. Yamaichi is not aware of the customer's end use/application. The customer indemnifies Yamaichi from any liability towards third parties in connection with the marking - with the exception of the legal exclusions of liability according to § 309 No. 7 BGB.